



AUTHORIZED ONSITE SOIL EVALUATORS (AOSEs) PO. Box 418 Ruckersville, VA 22968
 Jack McClelland/AOSE #098 (540) 948-7170 Tom Hogge/AOSE #240 (434) 985-2780

AOSE/PE Report for

Subdivision Approval 1

Location of property: Lot 1 Section , Subdivision Fairhill Estates, Albemarle County
 GPIN or Tax Map #
 Latitude/Longitude

Applicant or Client and address: David Mitchell/Southern Classic
Po Box 248
Crozet, VA 22932
 Prepared by AOSE/PE (name and address):
Tom Hogge - AOSE 240
Po Box 418
Ruckersville, VA 22968

Date of Report: 7/31/07 **AOSE/PE Job Number:** (optional)
Revision Date: , **Health Dept. ID. No.:**

Contents/Index of this report:
1-Cover 5-Site Sketch
2-Soil Summary 6-Abbrev. Design
3/4 Soil Descr.

Certification Statement(s)³

I hereby certify that the evaluations and/or designs contained herein were conducted in accordance with the Sewage Handling and Disposal Regulations (12 VAC5-610), the Private Well Regulations (12 VAC5-615), and other applicable policies of the Virginia Department of Health. Furthermore, I certify that my evaluation and/or design contained herein complies with all applicable laws, regulations, and policies implemented by the Virginia Department of Health.

I recommend a Subdivision ⁴ be Approved ⁵
Approval

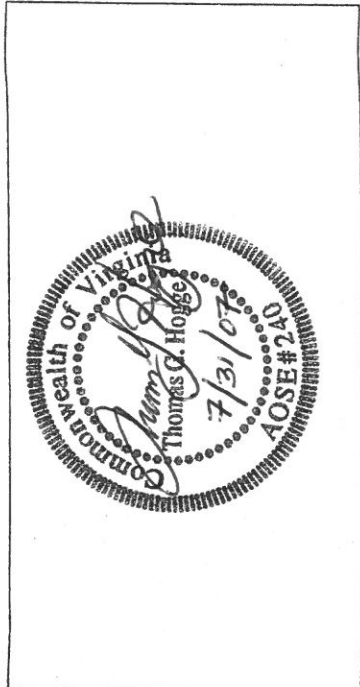

¹ Insert appropriate title: "Construction Permit", "Subdivision Approval", "Certification Letter"
² Examples include: "Soil Information Summary", "Soil Profile Descriptions", "Water Supply Design Specifications", "Primary/Reserve Design Specifications", "Construction Drawings", "Site Sketch", "Product Specification Sheet"
³ PE work is regulated by the Department of Professional and Occupational Regulation. This section is considered optional for PEs.
⁴ Fill in this blank with the appropriate term: "certification letter", "construction permit", or "subdivision approval"
⁵ Fill in this blank with the appropriate term: "approved", or "denied"

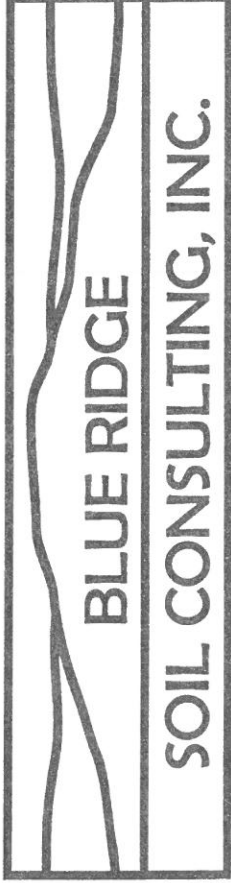

AUTHORIZED ONSITE SOIL EVALUATORS (AOSEs)

P.O. Box 418 Ruckersville, VA 22968

Jack McClelland/AOSE #098 (540) 948-7170 Tom Hogge/AOSE #240 (434) 985-2780

**Soil Evaluation Report
FAIRHILL ESTATES
Lot 1
Albemarle County, VA**

Owner:	David Mitchell c/o Southern Classic, Inc.	Phone:	(434) 823 - 7610
Mailing Address:	P.O. Box 248	Phone:	
	Crozet, VA 22932	Fax:	(434) 823 - 7645
Agent:	Blue Ridge Soil Consulting, Inc.	Phone:	(434) 985 - 2780
Mailing Address:	P.O. Box 418	Phone:	(540) 948 - 7170
	Ruckersville, VA 22968	Fax:	(434) 990 - 8367
Site Address:	Email:		
Directions to Property:	From Charlottesville, take Rt. 250 west past Rt. 250/Rt. 240 intersection. Property is on the right at Fairhill Lane		
Subdivision:	Fairhill Estates	Section:	
Tax Map:	Other Property Identification:	Block:	Lot: 1
		Dimension/Acreage of Property:	6.46 Acres



Soil Information Summary

1. Position in landscape satisfactory? Yes No
Describe: Sideslope
2. Slope: 18-19 %
3. Depth to Rock or impervious strata: Max. 60"+ Min. 60"+
4. Depth to seasonal water table (gray mottling or gray color): No Yes Inches
5. Free water present: No Yes range in inches
Yes Texture Group I II III IV
No Estimated rate 55 min/inch
6. Soil percolation rate estimated?
7. Permeability test performed Yes No

If yes, note type of test performed and attach

Soil Profile Descriptions
Fairhill Estates
Lot 1

Pit	Depth (in)	Horizon	Material Description	Soil Texture Group
1	0-11	A	10YR/4/3 Brown Loam/light Clay Loam	2/3
	11-22	Bt	5YR/4/6 Yellowish Red Silty Clay Loam with few weathered phyllite fragments	3
	22-32	CB	5YR/4/6 Yellowish Red light Silty Clay Loam/Silt Loam, variegated with 5YR/6/8 Reddish Yellow, 7.5YR/6/6 Reddish Yellow and 10YR/8/4 Very Pale Brown (parent)	3
	32-60	C	10YR/5/4 Yellowish Brown Silt Loam saprolite, variegated with 2.5Y/8/4 Pale Yellow and 2.5Y/7/2 Light Gray (parent), friable PIT TERMINATED AT 60"	3

2	0-7	A	10YR/4/6 Dark Yellowish Brown Loam/light Clay Loam	2/3
	7-24	Bt	5YR/4/6 Yellowish Red Silty Clay Loam with few weathered phyllite fragments	3
	24-37	CB	7.5YR/4/6 Strong Brown light Silty Clay Loam, variegated with 5YR/6/6 Reddish Yellow and 10YR/6/4 Light Yellowish Brown (parent)	3
	37-60	C	10YR/5/4 Yellowish Brown Silt Loam saprolite, variegated with 2.5Y/8/4 Pale Yellow and 2.5Y/6/3 Light Yellowish Brown (parent) PIT TERMINATED AT 60"	3



Soil Profile Descriptions, Continued

3	0-8	A	10YR/4/3 Brown Loam/light Clay Loam	2/3
	8-19	Bt	5YR/4/6 Yellowish Red medium Silty Clay Loam with few weathered phyllite fragments	3
	19-31	BC	5YR/4/6 Yellowish Red light Silty Clay Loam/Silt Loam, variegated with 5YR/6/6 Reddish Yellow and 7.5YR/4/6 Strong Brown (parent)	3
	31-60	C	10YR/5/4 Yellowish Brown Silt Loam saprolite, variegated with 10YR/6/8 Brownish Yellow and 10YR/7/3 Very Pale Brown	3
			PIT TERMINATED AT 60"	

4	0-10	A	10YR/4/6 Dark Yellowish Brown Loam/light Clay Loam	2/3
	10-22	Bt	5YR/4/6 Yellowish Red light Silty Clay Loam, medium	3
	22-60	C	10YR/5/8 Yellowish Brown Silt Loam saprolite, variegated with 10YR/6/3 Pale Brown and 2.5Y/8/3 Pale Yellow (parent) and common weathered phyllite fragments	3
				PIT TERMINATED AT 60"

5	0-8	A	10YR/4/4 Dark Yellowish Brown Loam	2
	8-24	Bt	7.5YR/5/6 Strong Brown Silty Clay Loam, SAB structure with few weathered phyllite fragments	3
	24-37	BC	5YR/4/6 Yellowish Red light Silty Clay Loam, variegated with 5YR/6/6 Reddish Yellow and 7.5YR/5/8 Strong Brown (parent), common mica	3
	37-60	CB	5YR/4/6 Yellowish Red very light Silty Clay Loam/Silt Loam, variegated with 10YR/7/2 Light Gray and 10YR/6/3 Pale Brown (parent), friable with common mica	3
			PIT TERMINATED AT 60"	



**BLUE RIDGE
SOIL CONSULTING, INC.**

AUTHORIZED ONSITE SOIL EVALUATORS (AOSEs)
P.O. Box 418 Ruckersville, VA 22968

Specializing in drainfield design
for subdivision development,
permits, certification letters,
and feasibility studies

Jack McClelland/AOSE #098
(540) 948-7170
Tom Hogge/AOSE #240
(434) 985-2780

PAGE 5 OF 6

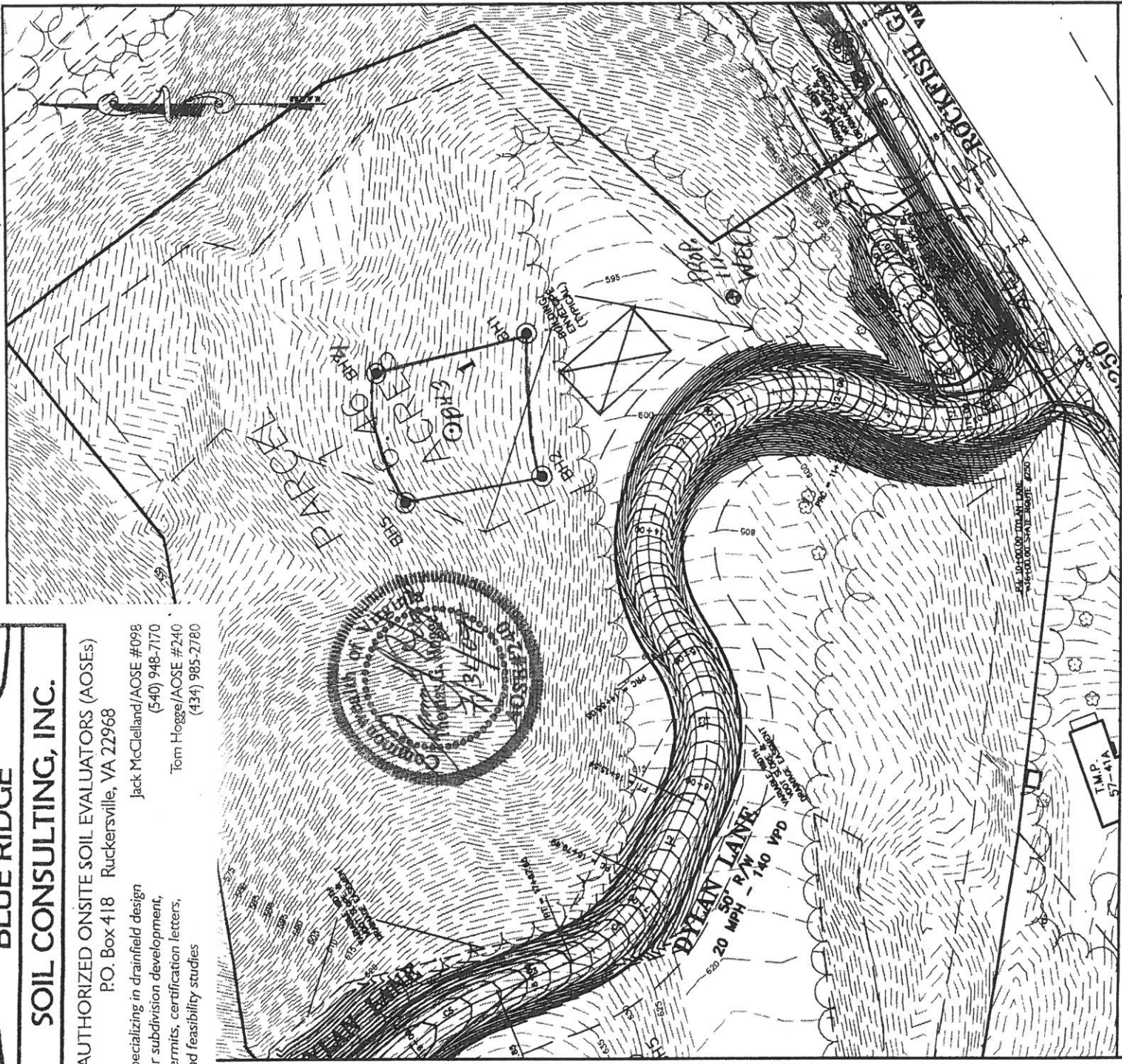

NOTES: REVISED 7-19-07	PROJECT # 20060711
	DATE: APRIL 17, 2007
	SCALE: 1" = 100'
	DRAWN BY: BCM
APPROVED BY:	



TOWNES
SITE ENGINEERING
9860 Lori Road, Suite 201
Charterfield, Virginia 23032
Phone: (804) 748-9011 Fax: (804) 748-2590
Email: townes@cctownes.com

DRAINFIELD LOCATION
LOT # 1
FAIRHILL ESTATES SUBDIVISION
ALBEMARLE COUNTY, VIRGINIA

Abbreviated Design Form
 Fairhill Estates
 Lot 1

Design Basis

- A. Estimated Percolation Rate (minutes per inch) 55 @ 42"
- B. Trench bottom square feet Required per bedroom (from Table 5.4) based on (X) Gravity ___ LPD ___ other 412
- C. Number of bedrooms 4



Area Calculations

- D. Length of trench (ft.) 100
- E. Length of available area (ft.) 100
- F. Width of trench (ft.) 3
- G. Number of trenches 12 (including reserve)
- H. Center-to-center spacing (ft.) 9
- I. Width required (ft.) 102
- J. Width of available area (ft.) 105-120
- K. Total square footage required 1648
- L. Square Footage in design 1800
- M. Is a reserve area required? Yes (100% reserve drainfield area is delineated)